

40/25 Cast in Channel

Technical Data

The ACS 40/25 channel is designed and tested for use in $\geq C 20 / 25$ concrete and all declared loads and edge distances are established for this designation of concrete. The allowable loads will ensure a minimum factor of safety of 3 is achieved against failure.

Installation & Best Practice

40/25 channel is supplied complete with a polystyrene infill to prevent the ingress of concrete during casting. Nail holes provided in the channel allow it to be attached to the timber formwork at a distance greater than the 100mm minimum edge distance.

When cutting channel on site the user must ensure that a tang is always positioned within 25mm of any free end to ensure the load capacity is achieved. ACS 40/25 channel is supplied in 3050mm lengths as standard.

Load Capacity

Tension kN	Shear kN	Longitudinal kN
8.00	10.00	2.00

Bolt Torque

Bolt Diameter mm	Tightening Torque Nm
M10	15
M12	25
M16	60

Material

ACS can supply 40/25 channel in grade 1.4301 (304) for all standard applications and 1.4401 (316) in applications requiring a greater level of corrosion resistance such as chemical and coastal applications.

Tang Detail

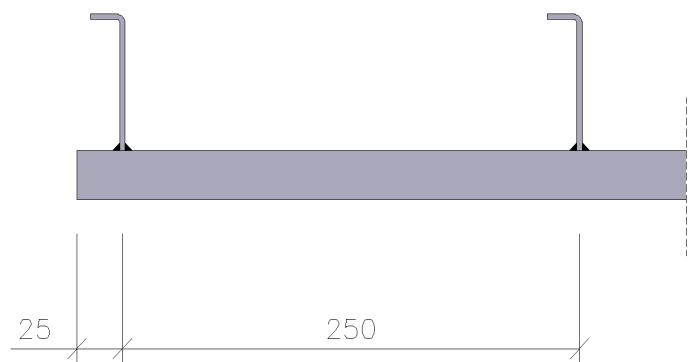

Section Detail

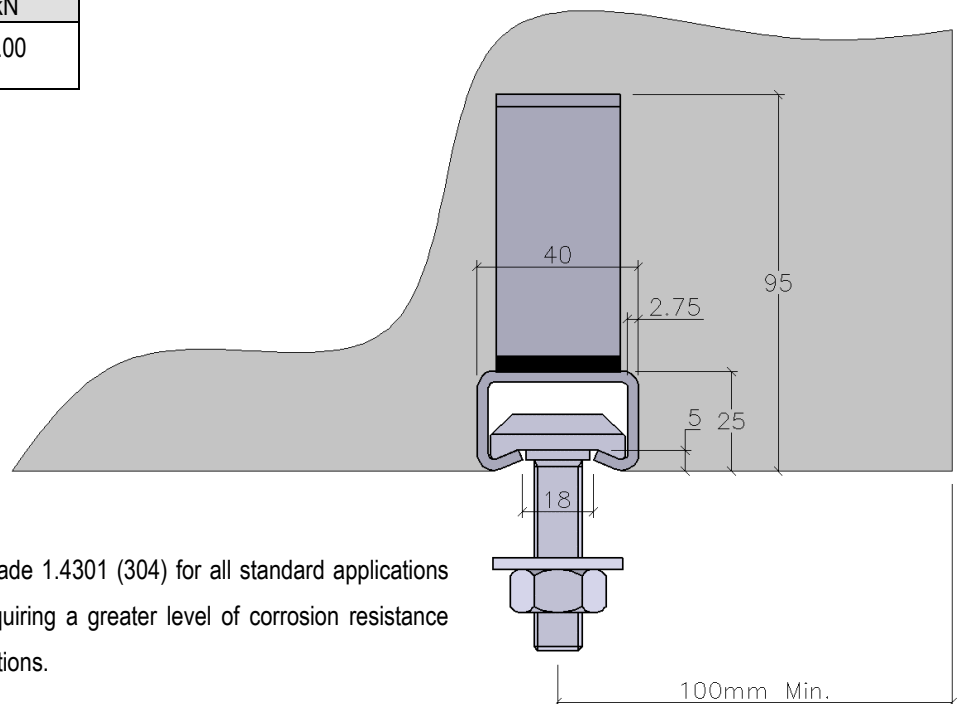

For further information or technical assistance please contact the ACS Technical Department on 0844 850 0860 or email technical@acsstainless.co.uk

LEEDS
Cross Green Approach
Cross Green Industrial Park
Leeds LS9 0SG
Tel: +44 (0)113 391 8200
Fax: +44 (0)113 391 8209

LONDON
Crown House
Home Gardens
Dartford
Tel: +44 (0)1322 424 510
Fax: +44 (0)1322 424 504

GLASGOW
Festival House
150 Brand Street
Glasgow G51 1DH
Tel: +44 (0)141 314 0048
Fax: +44 (0)141 314 0026

