

Implementation Date:



In Summary

- Every product covered by the CPR must carry a **genuine** CE mark before the implementation date of 1st July 2013
- It is a manufacturers responsibility to CE Mark any products it places onto the European Market after this date
- However, it is the Merchant, Supplier or Specifiers responsibility to ensure that all products it supplies or specifies on a project carry a genuine CE Mark
- To prove the validity of a CE Mark the manufacturer or supplier must be able to supply or provide evidence of:
 - Factory Production Control (FPC)
 - A Signed Declaration of Conformity/Performance
 - CE Mark Labels affixed to or accompanying every relevant product
 - A Technical Construction File
- ACS have tested every product in its range covered by the CPR and will have all the relevant documents in place before the impending implementation date in July 2013.

If you require any further information regarding the CPR or any aspect of CE Marking please feel free to contact the ACS Technical Department on +44 (0)113 391 8200 or technical@acsstainless.co.uk who are available to assist and advise as appropriate.



For more information please contact
ACS Stainless Steel Fixings Ltd

LEEDS

Cross Green Approach
Cross Green Industrial Park
Leeds LS9 0SG
Tel: +44 (0)113 391 8200
Fax: +44 (0)113 391 8209

LONDON

Crown House
Home Gardens
Dartford DA1 1DZ
Tel: +44 (0)1322 424 510
Fax: +44 (0)1322 424 504

GLASGOW

Festival House
150 Brand Street
Glasgow G51 1DH
Tel: +44 (0)141 314 0048
Fax: +44 (0)141 314 0026

TAUNTON

2 The Crescent
Taunton
Somerset TA1 4EA
Tel: +44 (0)843 178 7220
Fax: +44 (0)843 178 7221



Construction Products Regulation



Compulsory 1st July 2013

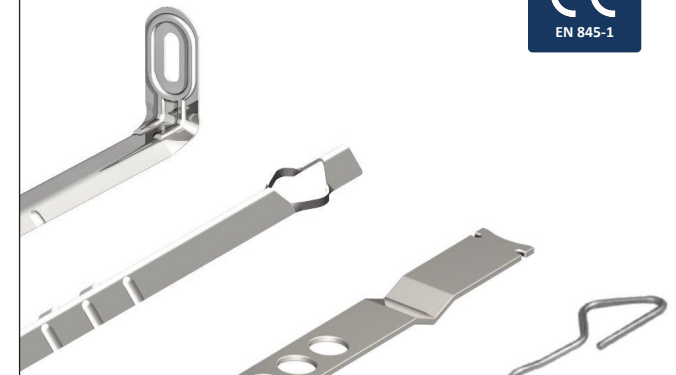

How will it affect you?

From the 1st of July 2013 the Construction Products Regulation (CPR) will become compulsory in the UK. This means that all products covered by the CPR that are sold after the implementation date must comply with this regulation.

It is the responsibility of the Buyer, Specifier or Merchant to ensure that products supplied to a site after the implementation date comply with the requirements of the CPR. This in short means that the products must carry a **genuine** CE mark.

To ease this process for our customer base, ACS has tested every product in our range that is covered by the CPR. These products include:

- Cavity Ties
- Frame Cramps
- Shear Ties
- Channel Ties
- Brackets
- Head Restraints
- Bed Joint Reinforcement
- Lintels
- Joist Hangers
- Tension Straps

You can therefore purchase ACS products with confidence after the implementation date knowing that all ACS products carry a genuine CE Mark and meet the requirements of the CPR.



Documentation

CE Declaration of Performance
Certificate N° 001CPR2013
ACS Frame Fix Ultra Channel Tie System

The ACS 25/15, Frame Fix Ultra, Channel Tie System is designed to allow an outer leaf of masonry to be tied to a light steel frame or other structural element, most commonly, but not exclusively through a rigid insulation board using a suitable fixing.

Designed, Manufactured and Supplied by:
ACS Stainless Steel Fixings Ltd
N°1 Cross Green Industrial Park
Leeds
West Yorkshire
LS9 0SG
United Kingdom

The product conforms to the EU Construction Products Regulation 305/2011
System of Assessment and Verification: System 3

Declared Performance

Performance Characteristic	Declared Performance	Harmonised Standard (hEN)
Embedment End	Tensile Load Capacity	4314N
	Compressive Load Capacity	4171N
Channel Tie End	Tensile Load Capacity	1107N
	Compressive Load Capacity	1836N
Water Shedding Capacity	Resistant or Non-Resistant	Resistant
Durability	Material of Coating Reference	B 3 (Stainless Steel)
Dangerous Substance	None	NFD

BS EN 845-1

Tests performed in line with requirements of BS EN 846-6:2006 by UKAS Accredited Notified Laboratory:
CEBAM
Queens Road
Penketh
Stoke-on-Trent
Staffordshire
ST4 7JZ
United Kingdom

The CE Mark affixed to the product is accordance with Directive 93/68/EC.

Declaration made by:
Signature: Date: 02/04/13
Mr David Flannery
Managing Director

Every product covered by CPR must have a signed declaration of performance, assuring the end user of the products conformity with the CPR and relevant Harmonised Standard (hEN)

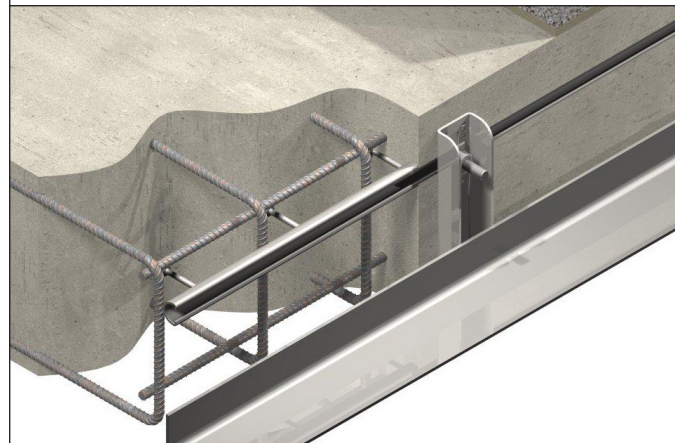

CE Labelling

Every product must be accompanied by a CE Label shown on the product (or when not possible it may be on the accompanying label, the packaging or on the accompanying commercial documents e.g. a delivery note)

CE

ACS Stainless Steel Fixings Ltd
N°1 Cross Green Approach
Cross Green Industrial Park
Leeds
West Yorkshire
United Kingdom
LS9 0SG
+44 (0) 113 391 8200
www.acsstainless.co.uk
2013

BS EN 845-1:2003
ACS Frame Fix Ultra – Channel Tie System

Stainless steel channel tie system for the connection of a masonry leaf to a light steel frame or other structural element to provide lateral restraint.

Embedment End
Tensile Load Capacity: 4314N
Compressive Load Capacity: 4171N

Channel Tie End
Tensile Load Capacity: 1107N
Compressive Load Capacity: 1836N

Water Shedding Capacity
Resistant

Durability
Material / Coating Reference 3

Dangerous Substance
N/A

The following information shall accompany the CE marking symbol:

- The year in which the CE mark was affixed
- Description of the product: generic name, material, dimensions and intended use
- Information on the relevant essential characteristics listed in Table ZA.1a of EN 845
- These values are to be declared and presented as declared values
- As an alternative, standard designation(s) alone or in combination with declared values as above