

Technical Data Sheet

ACS L7 Cavity Lintel

- ✓ Cavity Lintel
- ✓ 50 – 110mm Cavity
- ✓ Up to 4.8m as standard
- ✓ Heavy duty loading
- ✓ Stainless steel 304 or 316
- ✓ Galvanised Carbon Steel

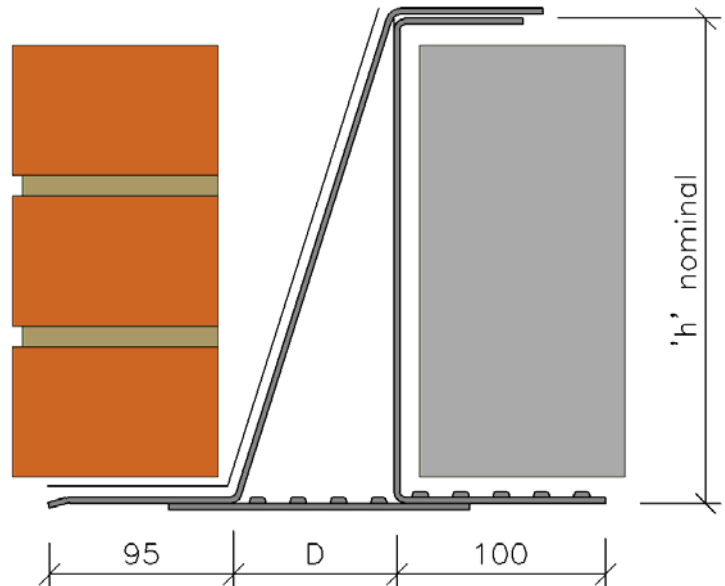

Technical Data

Maximum block dimensions 125mm

Load ratio 1 - applies to loads with an inner to outer leaf ratio of between 1:1 and 3:1

This ratio is normally applicable to lintels that support just masonry or masonry and timber floors

Load ratio 2 - ratio of between 4:1 and 19:1

This ratio is normally applicable to lintels supporting constructions with concrete floors or eaves applications

L7/50 ($D = 48\text{mm}$)

Manufactured Length (mm)	0600 – 1800	1950 – 2400	2550 – 3900	4050 – 4800	0600 – 4800
Height (mm)	228	228	228	228	228
Thickness (mm)	2.5	2.5	3.0	3.0	3.0
Allowable UDL (kN) Load ratio (1)	50	50	50	40	45
Allowable UDL (kN) Load ratio (2)	50	50	50	40	45
I_{xx} (cm ⁴)	1520	1520	2069	2069	2173
Z_{xx} (cm ³)	104.00	104.00	152.00	152.00	163.00
Finished Weight (kg/m)	16.28	16.28	20.33	20.33	20.80

Technical Data Sheet

L7/75 ($D = 68\text{mm}$)

Manufactured Length (mm)	0600 – 1800	1950 – 2400	2550 – 3900	4050 – 4800	0600 – 4800
Height (mm)	228	228	228	228	228
Thickness (mm)	2.5	2.5	3.0	3.0	3.0
Allowable UDL (kN) Load ratio (1)	50	50	50	40	45
Allowable UDL (kN) Load ratio (2)	50	50	50	40	45
I_{xx} (cm ⁴)	1801	1801	2101	2101	2482
Z_{xx} (cm ³)	127.00	127.00	151.00	151.00	186.00
Finished Weight (kg/m)	17.76	17.76	20.82	20.82	24.24

L7/100 ($D = 94\text{mm}$)

Manufactured Length (mm)	0600 – 1800	1950 – 2400	2550 – 3900	4050 – 4800	0600 – 4800
Height (mm)	228	228	228	228	228
Thickness (mm)	2.5	2.5	3.0	3.0	3.0
Allowable UDL (kN) Load ratio (1)	50	50	50	40	45
Allowable UDL (kN) Load ratio (2)	50	50	50	40	45
I_{xx} (cm ⁴)	1970	1970	2303	2303	2510
Z_{xx} (cm ³)	129.00	129.00	154.00	154.00	174.00
Finished Weight (kg/m)	18.64	18.64	21.78	21.78	22.72

For further information or technical assistance please contact the ACS Technical Department on 0870 850 0860 or email technical@acsstainless.co.uk

LEEDS
Cross Green Approach
Cross Green Industrial Park
Leeds LS9 0SG
Tel: +44 (0)113 391 8200
Fax: +44 (0)113 391 8209

LONDON
Crown House
Home Gardens
Dartford
Tel: +44 (0)1322 424 510
Fax: +44 (0)1322 424 504

GLASGOW
Festival House
150 Brand Street
Glasgow G51 1DH
Tel: +44 (0)141 314 0048
Fax: +44 (0)141 314 0026

