

Technical Data Sheet

ACS L5 Cavity Lintel

- ✓ **Cavity lintel**
- ✓ **Wide Inner Leaf**
- ✓ **50 – 100mm Cavity**
- ✓ **Up to 4.2m as standard**
- ✓ **Standard duty loading**
- ✓ **Stainless steel 304 or 316**
- ✓ **Galvanised Carbon Steel**

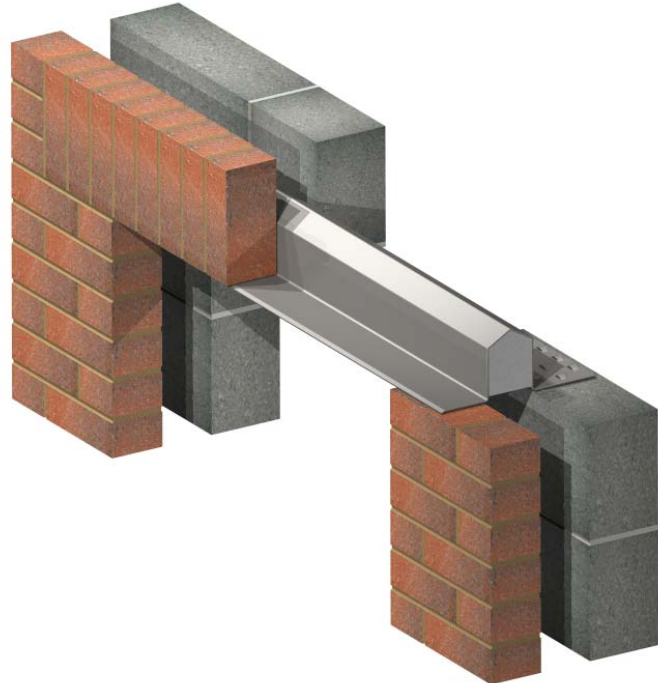

Technical Information

Maximum block dimensions 150mm

Load ratio 1 - applies to loads with an inner to outer leaf ratio of between 1:1 and 3:1

This ratio is normally applicable to lintels that support just masonry or masonry and timber floor joists

Load ratio 2 - applies to loads with an inner to outer leaf ratio of between 4:1 and 19:1

This ratio is normally applicable to lintels supporting constructions with concrete floors or eaves applications

L5 Lintels

L5 type lintels offer distinct advantages in terms of durability and structural characteristics including:

- Uniform and continuous bricklaying due to the upstand of the lintel sitting within the clear cavity
- Excellent thermal efficiency due to the expanded polystyrene infill (standard on all L5 lintels) providing a 'U' value through the lintel of less than 0.33 W/m²K
- Reduced maintenance costs through the elimination of cracked plaster due to the differential expansion of dissimilar materials associated with Box Section Lintels.
- Semi-pierced slots on the inner flange give an excellent key for the plaster finish.

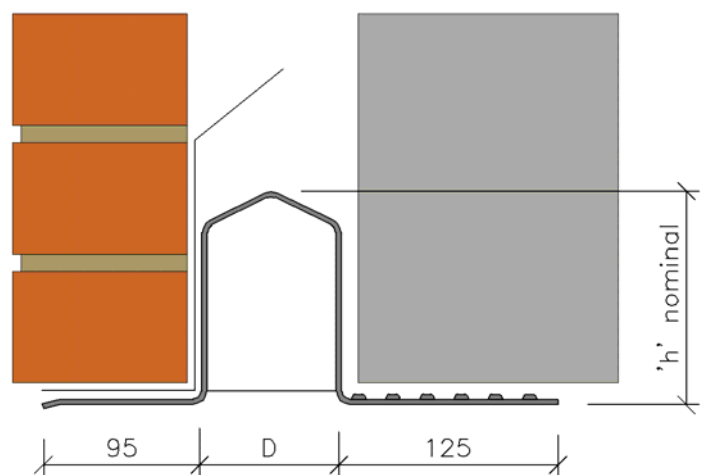

Technical Data Sheet

L5/50 WIL ($D = 48mm$)

Manufactured Length (mm)	0600 – 1500	1650 – 2100	2250 – 2400	2550 - 2700	2850 - 3000	3150 - 3600	3750 – 4200
Height (mm)	103	140	152	177	180	180	210
Thickness (mm)	2.5	2.5	2.8	2.8	2.8	3.0	3.0
Total Allowable UDL (kN) Load Ratio 1	15	22	23	25	30	30	28
Total Allowable UDL (kN) Load Ratio 2	12	17	17	19	24	24	24
I_{xx} (cm ⁴)	139.4	307.6	423.7	627.6	721.5	771.2	1154.9
Z_{xx} (cm ³)	19.21	32.43	41.66	54.08	57.69	61.71	80.84
Finished Weight (kg/m)	8.64	10.11	11.87	12.97	14.22	15.15	16.56

L5/75 WIL ($D = 68mm$)

Manufactured Length (mm)	0600 – 1500	1650 – 1800	1950 – 2400	2550 – 2700	2850 - 3000	3150 - 3600	3750 – 4200
Height (mm)	97	133	146	171	174	174	204
Thickness (mm)	2.5	2.5	2.8	2.8	2.8	3.0	3.0
Total Allowable UDL (kN) Load Ratio 1	15	18	23	25	30	30	28
Total Allowable UDL (kN) Load Ratio 2	12	16	17	19	24	24	24
I_{xx} (cm ⁴)	127.2	285.3	403.4	603.8	695.6	743.5	1122.5
Z_{xx} (cm ³)	18.86	32.04	41.81	54.52	58.12	62.17	81.68
Finished Weight (kg/m)	8.64	10.11	11.87	12.97	14.54	15.47	16.88

Technical Data Sheet

L5/100 WIL ($D = 94\text{mm}$)

Manufactured Length (mm)	0600 – 1200	1350 – 1500	1650 – 1800	1950 – 2100	2250 – 2400	2550 – 2700	2850 - 3600	3750 - 4200
Height (mm)	87	112	124	136	161	161	164	194
Thickness (mm)	2.5	2.5	2.8	2.8	2.8	3.0	3.0	3.0
Total Allowable UDL (kN) Load Ratio 1	14	15	17	22	23	25	30	28
Total Allowable UDL (kN) Load Ratio 2	12	12	14	17	17	19	24	24
I_{xx} (cm ⁴)	99.52	191.6	251.4	359.0	550.2	589.1	662.9	1020.5
Z_{xx} (cm ³)	16.71	25.70	30.70	40.29	53.25	57.01	59.97	79.61
Finished Weight (kg/m)	8.64	9.62	10.11	11.87	12.97	13.90	15.78	17.19

For further information or technical assistance please contact the ACS Technical Department on 0870 850 0860 or email technical@acsstainless.co.uk

LEEDS
Cross Green Approach
Cross Green Industrial Park
Leeds LS9 0SG

Tel: +44 (0)113 391 8200
Fax: +44 (0)113 391 8209

LONDON
Crown House
Home Gardens
Dartford

Tel: +44 (0)1322 424 510
Fax: +44 (0)1322 424 504

GLASGOW
Festival House
150 Brand Street
Glasgow G51 1DH

Tel: +44 (0)141 314 0048
Fax: +44 (0)141 314 0026

